

Inside this issue:

The Research Foundation Recognition Reception.....1-3

The Buffalo McNair Scholars Program: Helping Scholars In Pursuit of the Ph.D.....4-5

Buffalo State Virtual Educational Island Sponsored by the Research Foundation6-9

Awards10-11



Guests enjoy Recognition Reception at the Historical Society.

Research Foundation Recognition Reception Held April 23

The 10th Annual Research Foundation Recognition Reception was held on Monday, April 23, 2007, at the Buffalo and Erie County Historical Society. The event was established by Research Foundation Director Ted Turkle with the purpose of recognizing the work of the numerous faculty and staff of the College who support the Research Foundation mission as Project Directors, Research Foundation Committee members, or as Incentive Award recipients.

Dr. Muriel Howard, President, welcomed reception participants and Dr. Dennis K. Ponton, Provost and Ted Turkle, Research Foundation Director, presented the awards. For the second year, The Research Foundation recognized Project Directors whose efforts have resulted in \$1,000,000 or more in grants and contracts between 2000 and 2006.

There are three new members of the **“The Million Dollar Club”** bringing the total to 24. New members include: **Susan A. McCartney**, *Director Small Business Development Center*, **Dr. Susan E. McMillen**, *Associate Professor Mathematics*, **Dr. Sandra D. Washington**, *Director McNair Scholars Program*.

All members of “The Million Dollar Club” will be recognized on a permanent plaque which will be on display in the Research Foundation offices.

Continued on page 2

Continued from cover story

In addition, four Research Foundation employees were recognized for ten years of service and three were recognized for five years of service.

Dr. Jill Singer, Director of the Office of Undergraduate Research, presented the Undergraduate Summer Research Fellowship Recipients who also were honored at the event. They include:

SCHOOL OF ARTS AND HUMANITIES

Angela McCormack

Faculty Mentor: Professor Robert Wood, Design

Kimberly Gehl Davis

Faculty Mentor: Professor Stephen

Saracino, Design

Carla Young

Faculty Mentor: Professor William Raffel,

Communication

Robert J. Klinshaw II

Faculty Mentor: Professor Gregory Dale

Smith, Art Conservation

Robert R. Turley, Jr.

Faculty Mentor: Professor Lisa Berglund,

English

Melanie Beitel

Faculty Mentor: Professor Richard Ross, Design

Eric Moslow

Faculty Mentor: Professor

Carol Beckley, Theater

Lizabeth Kelley

Faculty Mentor: Professor

Tara J. Stephenson, Design



(from left) Courtney Cox, Carol Darstein and Ted Turkle received ten-year service awards at the Recognition Reception. Sandra Cochran (not pictured) also was recognized.

SCHOOL OF THE PROFESSIONS

Inna Sen

Faculty Mentor: Professor Christine M.

Scott, Speech-Language Pathology

SCHOOL OF NATURAL AND SOCIAL SCIENCES

Erin Carr

Faculty Mentor: Professor

Dwight Hennessy, Psychology

Christopher Janik,

Faculty Mentor: Professor

Christopher Pennuto, Biology

Lindsay L. LaFleur

Faculty Mentor: Professor Gary Solar,

Earth Sciences and Science Education

Mathew Tarasek

Faculty Mentor: Professor

Kimberly Bagley, Chemistry

Nayrobi M. Rodriguez Vasquez

Faculty Mentor: Professor Simon

Peter Gomez, Political Science

Yvonne Woolwine

Faculty Mentor: Professor

I. Martha Skerrett, Biology

Edward Fazekas

Faculty Mentor: Professor

Peter R. Mercer, Mathematics



(from left) Gina Ngo, Judy Heintz, and Stephanie Gruarin were recognized for five years of service to the Research Foundation.



Dr. Muriel Howard and Zhang Jie enjoy the reception.

A special thanks to all who have served on Research Foundation Committees in 2006-07:

RESEARCH AND CREATIVITY COUNCIL (RCC)

Catherine Ansuini, *Professor, Health and Wellness; RCC Chair*

Bruce Baum, *Professor, Exceptional Education*

Elisa Bergslien, *Assistant Professor, Earth Sciences and Science Education*

Mark Fulk, *Associate Professor, English*

Gina Game, *RCC Reporting Secretary, Research Foundation of SUNY, Buffalo State College*

Linda Gleckel, *Interim Associate Dean, School of Education*

Stephanie Goldberg, *Professor, Technology*

Lisa Hunter, *Assistant Professor, Music*
Gerri Hura, *Assistant Professor, Educational Foundations*

Scott Johnson, *Assistant Dean, First-Year and Academic Support Programs*

Richard Lee, *Interim Dean, Graduate School*

Carolyn Ann Morris-Hunt, *Director, External Development, Institutional Advancement*

Karen O'Quin, *Associate Dean, School of Natural and Social Sciences*

Alicia Perez-Fuentetaja, *Associate Professor, Biology*

Kerran Sanger, *Interim Associate Dean, School of Arts and Humanities*

Jill Singer, *Professor, Earth Sciences and Science Education; Director, Office of Undergraduate Research*

Ted Turkle, *Director, Research Foundation of SUNY, Buffalo State College*

Rita Zientek, *Associate Dean, School of the Professions*

INSTITUTIONAL REVIEW BOARD (IRB)

Linda Dubrawsky, *Associate Director of Finance and Grants Management, Research Foundation of SUNY, Buffalo State College*

Stephanie Goldberg, *Professor, Technology*

George Hole, *Chair and Distinguished Teaching Professor, Philosophy and Humanities*

Jill Norvilitis, *Associate Professor, Psychology; IRB Chair*

Lori Quigley, *Associate Professor, Elementary Education and Reading*

Brian Same, MD, *Buffalo Otolaryngology Group*

Ron Stewart, *Professor, Sociology*

Ted Turkle, *Director, Research Foundation of SUNY, Buffalo State College*

William Wieczorek, *Director, Center for Health and Social Research*

INSTITUTIONAL ANIMAL CARE USE COMMITTEE (IACUC)

Penny Danielewicz, *Animal Keeper, Buffalo Zoo*

Jean DiPirro, *Assistant Professor, Psychology; IACUC Chair*

John Freidhoff, *Boat Captain/Field Station Manager, Great Lakes Center*

Christina Kieber, *Feline Specialist, Buffalo Zoo*

Amy McMillan, *Assistant Professor, Biology*

David Miller, *Director, Environmental Health and Safety*

Scott Nachbar, DVM, *Veterinarian*

Ted Turkle, *Director, Research Foundation of SUNY, Buffalo State College*

Thomas White, *Associate Professor, Biology*



Undergraduate Summer Research Fellowship recipients and their mentors.

The Buffalo McNair Scholars Program: Helping Scholars In Pursuit of the Ph.D.

By Sandra D. Washington, Ph.D.
Director, McNair Scholars Program

The Ronald E. McNair Post-Baccalaureate Achievement Program is named in Honor of Dr. Ronald E. McNair, the laser physicist and astronaut who perished when the Challenger space shuttle exploded in 1986. Funded through a grant from the United States Department of Education, the Buffalo State McNair Program is designed to encourage intellectually gifted undergraduates to consider enrolling in graduate programs in various disciplines, and beyond this, to complete the Ph.D. and enter the academy as college and university professors and researchers. Charged with the mission of helping increase the diversity of college and university faculty, the McNair Program is centered on increasing the number of low-income, first-generation and underrepresented minority college students who pursue and complete the doctoral degree. This is done by providing the opportunity for students to conduct research under the guidance of faculty mentors in

preparation for the rigors of graduate study. Students accepted to the program attend a series of colloquia, receive training for the Graduate Record Exam (GRE) and are trained to present the results of their research at local, regional, and national academic conferences.

One of our graduating seniors majoring in Speech Language Pathology, Guemali Viera, is working in conjunction with her mentor, Dr. Deborah M. Insalaco, on a research project entitled, "A Survey of Post-Stroke Services for the Hispanic Community of Buffalo." Her study seeks to answer the question of whether or not the Hispanic community is being served adequately in the post-stroke population. In her study she will survey two groups of subjects about existing post-stroke services for the Hispanic community. The researcher designed questionnaire also asks about stroke survivors' perception of the quality of services received. She will also interview health care professionals.

Recently, Guemali presented her research project at the University of Maryland College Park and at Buffalo State College's Student Research and Creativity Celebration. She credits the McNair program for igniting her desire to achieve a Ph.D. She feels that the program has been paramount in her academic development and is certain that her experience in conducting research as an undergraduate student has provided her with a distinct advantage as she enters her career field. This opportunity also cemented her

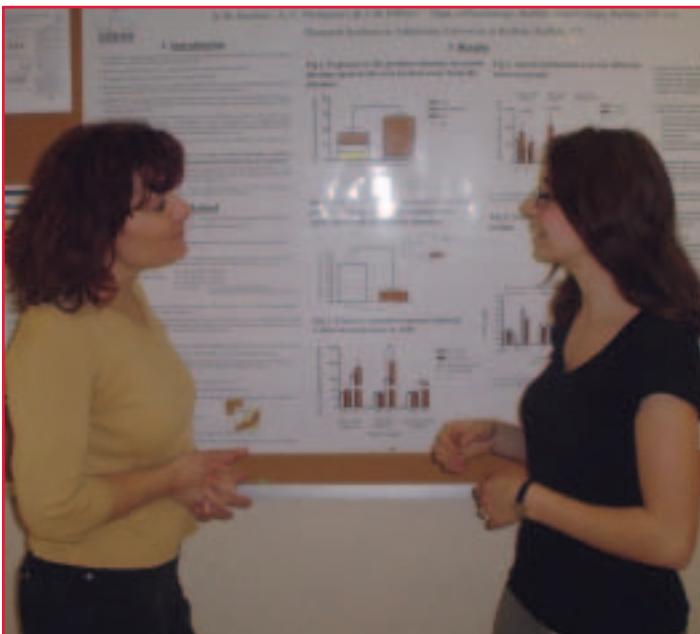

Mentor Dr. Jean DiPirro helps prep Natalie Sciolino for her presentation at the Eastern Psychological Associates Annual Conference.



McNair Scholar, Natalie Sciolino is habituating rats to being held in order to reduce the likelihood of experimenter handling to act as a stressor before testing.

decision toward becoming a Speech-Language Pathologist and helped focus her specific interests in the field. She will attend New York University (NYU) for her MS in Speech-Language Pathology. Her goal is to eventually earn a Ph.D in the same field with a concentration in bilingualism and neurogenic communication disorders. She hopes to work with the adult Hispanic population as well as those populations in poverty. Because of this program, Guemali's ambition for the future has grown from a simple desire to practice as a speech-language pathologist, to now actually wanting to head her own rehabilitation center.

One of our junior Scholars, Natale Sciolino, is working with Dr. Jean DiPirro on her research project and is interested in pursuing a Ph.D. in Behavioral Neuroscience. She is currently majoring in Biological Psychology with a minor in Chemistry.

Natale's first research project employed a Predator Scent Model of Stress, a model-in-development of Posttraumatic Stress Disorder (PTSD) in female rats. She exposed rats to a predator (cat) scent, which is a stressor that may induce PTSD-like physiology and behavior. She found that predator (cat)-scent exposed rats showed a defensive response to the cat scent, which supports the idea that cat scent is fear-inducing in female rats. In addition, she found that cat-scent exposure increased acoustic startle response, a major symptom of PTSD, immediately after cloth exposure in female rats. This semester, she presented her research at the 2007 Eastern Psychological Association Conference (EPA) held in Philadelphia and the Research and Creativity Day Celebration. Natale is currently working on her Honors Thesis project, which will also employ the Predator Scent Model of Stress to investigate, in male rats, the role of the anticonvulsant Topiramate in preventing PTSD-like symptoms from occurring after exposure to "traumatic" stressor. She will investigate the effects of predator (cat) scent on the reflexive acoustic startle response, prepulse inhibition (a measure of sensorimotor gating), and defensive behavior. She intends to publish this research in a professional journal.

Natale is also employed by the University at Buffalo's Research Institute on Addictions (RIA). She works as a research technician on a project for Dr. Roh-Yu Shen and examines the influence of methylphenidate (Ritalin) exposure, in childhood and adolescent rats, on behavioral sensitivity to cocaine in adulthood. This summer she will assist Dr. Jean DiPirro and Dr. Alexis Thomson on their



Guemali Viera presents her research to McNair Scholars Darryl Hamilton and Flavra Rivera.

grant to assess the effects of neuropeptide Y (NPY) as a target in the treatment of cocaine dependence. They will examine the influence of NPY on cue-induced cocaine seeking, drug-induced and stress-induced reinstatement of cocaine seeking, and anxiety associated with withdrawal from cocaine.

The McNair program has helped her to realize that research is very rewarding. She is excited to continue to progress in her career as a researcher and will apply to graduate school next Fall.

First funded in 1999, the McNair support staff serves approximately 24 students annually and has served a total of 96 students. Currently, six graduates of our program are enrolled in a Ph.D. program and ten are in Masters programs in a wide variety of fields, at institutions across the country. To date, 16 students have completed their graduate studies. We are exceptionally proud of the successes of all our students, both inside and outside of the classroom and the laboratory. McNair Scholars have both the intellect and the energy to change the world and the way knowledge is produced and disseminated in their respective disciplines. The Program is an important member of the Buffalo State College community and is an important part of the College's integration of undergraduate research into the curriculum.



Some avatars of the Fashion CAD group gather on the Buffalo State Second Life Island.

Buffalo State Virtual Educational Island Sponsored by the Research Foundation

A “virtual world” is defined as an interactive simulated environment accessed by multiple users through an online interface. Virtual worlds are characterized by:

1. **Shared Space:** many users participate at once.
2. **Graphical User Interface:** the world depicts space visually, ranging in style from 2D to more immersive 3D environments.
3. **Immediacy:** interaction takes place in real time.
4. **Interactivity:** the world allows users to alter, develop, build, or submit customized content.
5. **Persistence:** the world’s existence continues regardless of whether individual users are logged in.
6. **Socialization/Community:** the world allows and encourages the formation of in-world social groups like teams, guilds, clubs, cliques, and neighborhoods.

One virtual world, *Second Life* has emerged as a cutting-edge virtual classroom for colleges and universities including Harvard, Pepperdine, Elon University, Ohio University, Ball State, New York University, and Stanford University. Rebecca Nesson, an instructor at Harvard who brought her Legal Studies class to *Second Life* in 2006 has said, “Normally, no matter how good a distance-learning class is, an inherent distance does still exist between you and your students. *Second Life* has really bridged that gap. There is just more unofficial time that we spend together outside of the typical class session.”

An official BSC SL Campus Pilot group led by Elaine Polvinen was formed in January 2007 to explore, research and develop a plan for campus-wide introduction to Second Life. The focus for the initial spring 2007 semester has been preparing to introduce SL to the campus and researching the technical support and hardware requirements for making SL available campus wide. All members of this group try to mentor or advise wherever needed to inform, encourage or assist with projects or research conducted by other members of the BSC college campus.

After researching other educational institutions it was determined that the privacy advantages to owning a private educational island would facilitate the BSC SL Campus Pilot group, exploratory faculty projects and students interested in investigating Second Life. In February, the Research

Foundation sponsored the purchase of a 16 acre virtual educational island in Second Life named Buffalo State.

While under development, the Buffalo State Island is not open to the public. The BSC SL Pilot Group was formed in Second Life and members of the group were added to allow access to the private educational island. As the island is developed, portions of it will be opened to visitor group members.

To encourage collaborations, several introductory workshops as well as one-on-one meetings were held in the Fashion Technology CAD lab in Caudell Hall, the current primary location for accessing Second Life on the BSC campus. This and several other single computers on campus are currently the primary locations for Second Life access on the campus until the Computing and Technology Services support group led by Melissa Miskiewicz, Director of Academic Computing can successfully resolve hardware and security issues related to Second Life. Paul Reynolds, Manager of Training & Consulting from Computer and Technology Services and Ken Fujiuchi, Emerging Technologies Librarian, are researching introductory workshops for introducing and integrating 3D virtual elements into a wide array of coursework for BSC faculty members.

BSC SL Pilot group members were encouraged to join the various educator list serve and research support groups available through the Second Life educator section. Faculty members from Performing Arts, Design, CASTL, Exceptional Education, CIS, COM, Creative Studies, Math and Science expressed interest in learning more about SL.

Stephanie Belhomme, a graduate student from Creative Studies joined the group with a research interest in the creative problem solving applications of Second Life as well as researching the variety of educational possibilities and the SNOODLE application which integrates the free open source course management system [MOODLE] with a 3D virtual learning environment like Second Life. She presented her SL activities at the Scholarship and Creativity Celebration in a presentation titled *“Myriad Mosaic/Second Life @ BSC: Building Knowledge; Developing Ideas, Information, and Products.”*

In an effort to get as many students involved as possible undergraduate students from several areas were invited to join the BSC Pilot group in SL to research various aspects of SL such as economy, politics, science, scripting, building, art & design, fashion, and a variety of educational possibilities. Bill Lin’s [CIS] group is exploring hardware and security issues in collaboration with Computing and

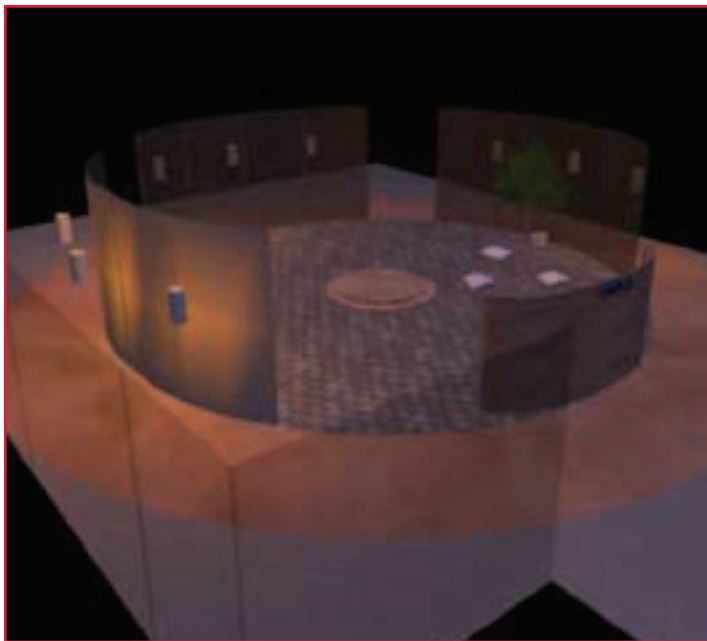

The Butler Rooftop Poetry Group Center.

Technology Services as well as business feasibility in Second Life. Joaquin Carbonara’s [MAT] group was exploring the math/science applications in Second Life. Xiao Wang, a Multidisciplinary Studies graduate student from China who is studying with Dr. Tao Tang in the Geography Department is working on the land terrain of the Buffalo State island.

A Second Life project for the undergraduate level was integrated into the spring 2007 Fashion CAD class in the Fashion Technology Program as a test prototype for a future course revision. Fashion students integrated their own surface design as well as garment designs into Second Life. Their fashion project also incorporated Jozef Bajus [DES] fiber design student work. In this initial test project fashion students research virtual fashion designers that have developed fashion design businesses in SL. Fashion students also develop and see their own surface and garment designs in three dimensional reality in SL, develop their presentation skills in 3D, learn how to prepare and sell virtual goods in SL, and develop a final fashion presentation and/or exhibition in SL.

The fashion students began the SL project by learning the basics of creating an avatar navigating on the ground and in the air, organizing files and changing appearance in Second Life. When they felt more comfortable about the basics, they began to make different outfits using the Appearance function. Once they created an outfit they liked they learned how to pose and photograph their fashionable

Continued on page 8

avatar in SL and prepare the posed image for inclusion on a Web page that was created to introduce all the Fashion CAD project student avatars.

Fiber design student works were prepared and uploaded to SL to be used as surface textures for coordinated apparel outfits fashion students are developing for the SL fashion project. The fiber student textures will be available for other visitors to the Buffalo State Island to use in SL.

Fashion students will create sequentially more challenging fashion outfits using their own designs that were created earlier in the class while learning other applications. They will also explore the use of additional 3D virtual design applications to develop more complex garment designs.

Students will contribute to the development of animated video clips and/or Web pages of their garment collections. They will place their customized fashion mannequin

and fashion outfit collections in a Fashion CAD exhibit on the Buffalo State Island for anyone to copy the outfits to use for their avatar. They also plan to finalize their project with a fashion show in SL.

During the course of this project Fashion CAD students are contributing to development of a Web presentation that will document the process we experienced with this SL project so others can use it as a prototype for their SL exploration. Web pages, Images and video clips of the SL Fashion CAD project are developed and posted on the Web at:
<http://www.bscsecondlife.info>

Simultaneously, the BS SL Pilot group has been initiating low key planning and development of the island to begin to formulate a presence for the institutional area, faculty, staff and students and a public sandbox area where invited guests can build.

When the Buffalo State Island first became available at the end of

February, an info pad was constructed by Elaine Polvinen to serve as an information hub for all island members. This area also served as a test area for streaming video, linked Web pages and Podcasts. Once this was completed two skypads were installed for members to use. Teleporters were placed at the info hub for instant travel back and forth.

Maryruth Glogowski, Associate VP of Library and Instructional Technology, and Maureen Lindstrom, Associate Director for Information Commons, lead the active SL Butler group. In the last month a temporary library building for the Butler group was constructed by Elaine Polvinen. Sketches developed by Dennis Reed, Assistant Web Editor/Library Communications Associate, served as a guide for additional construction of the Rooftop Poetry Area. The SL Library and Rooftop Poetry area are currently being furnished by the Butler group. The group is also organizing a listing of SL teaching tools, tutorials, resources and links to assist the BS community

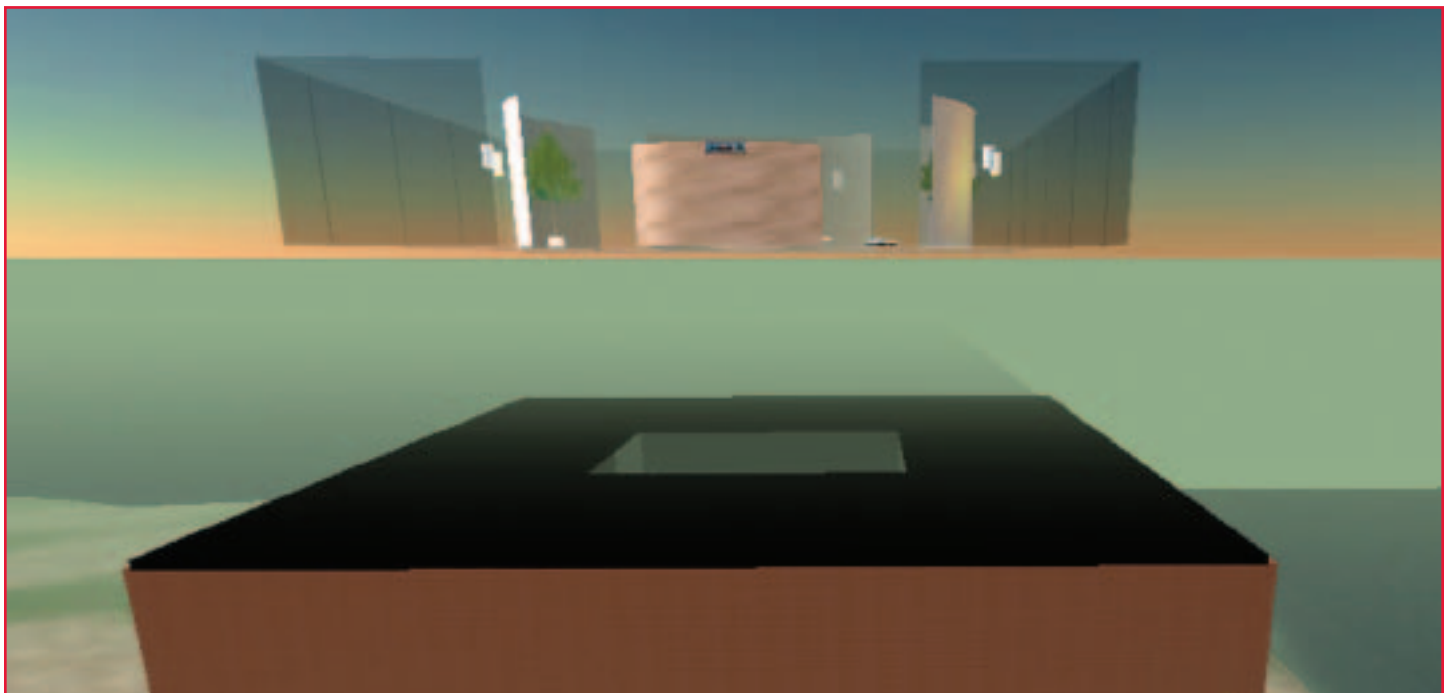

Construction is underway on the Buffalo State Island.

with using Second Life as a virtual teaching tool. In addition to the creation and development of the Rooftop Poetry group, they have some really exciting plans for future development in Second Life including conferences, events and orientation for new students. Orientation for new students would serve as an excellent collaborative effort with University College. International Studies and Student Exchange is also working with the BS SL Pilot group to develop a presence in Second Life.

Ken Fujiuchi, Emerging Technologies Librarian, and Heather Glogowski, a Reference and Instruction Librarian, are members of the Butler group within the BSC pilot project. They are exploring how the Second Life software can enhance library services to the campus community and beyond. Heather is

collaborating internationally with other SL Librarians on a virtual library catalog for SL, and she is doing her own research on the potential of the software for use by educational institutions. She will present her findings at the upcoming Educational Technology Conference, 2007

(<http://www.buffalostate.edu/depts/edcomputing/etc07/index.html>), in the lecture titled, "Second Life: Exploring the Possibilities, Limitations, and General Feasibility of Use as an Educational Tool."

Plans for summer 2007 phase of the Second Life project involve preparation and scheduling a series of Introduction to SL workshops for fall 2007, creating a more developed institutional presence on the Buffalo State SL island as well as facilities for faculty that would use virtual offices, classroom or conference facilities in SL for their creative teaching and/or research.

Currently the BSC SL Pilot group is comprised of faculty, staff, administration, undergraduate and graduate students. Anyone interested in research and/or teaching in Second Life or scheduling a small group introduction to SL should contact Elaine Polvinen, polvinem@buffalostate.edu. Joaquin Carbonara set up a WIKI for the BS SL pilot groups where the group notes and video clips are posted: <http://www.bscsecondlife.info/>

Elaine Polvinen was a major contributor to this article.

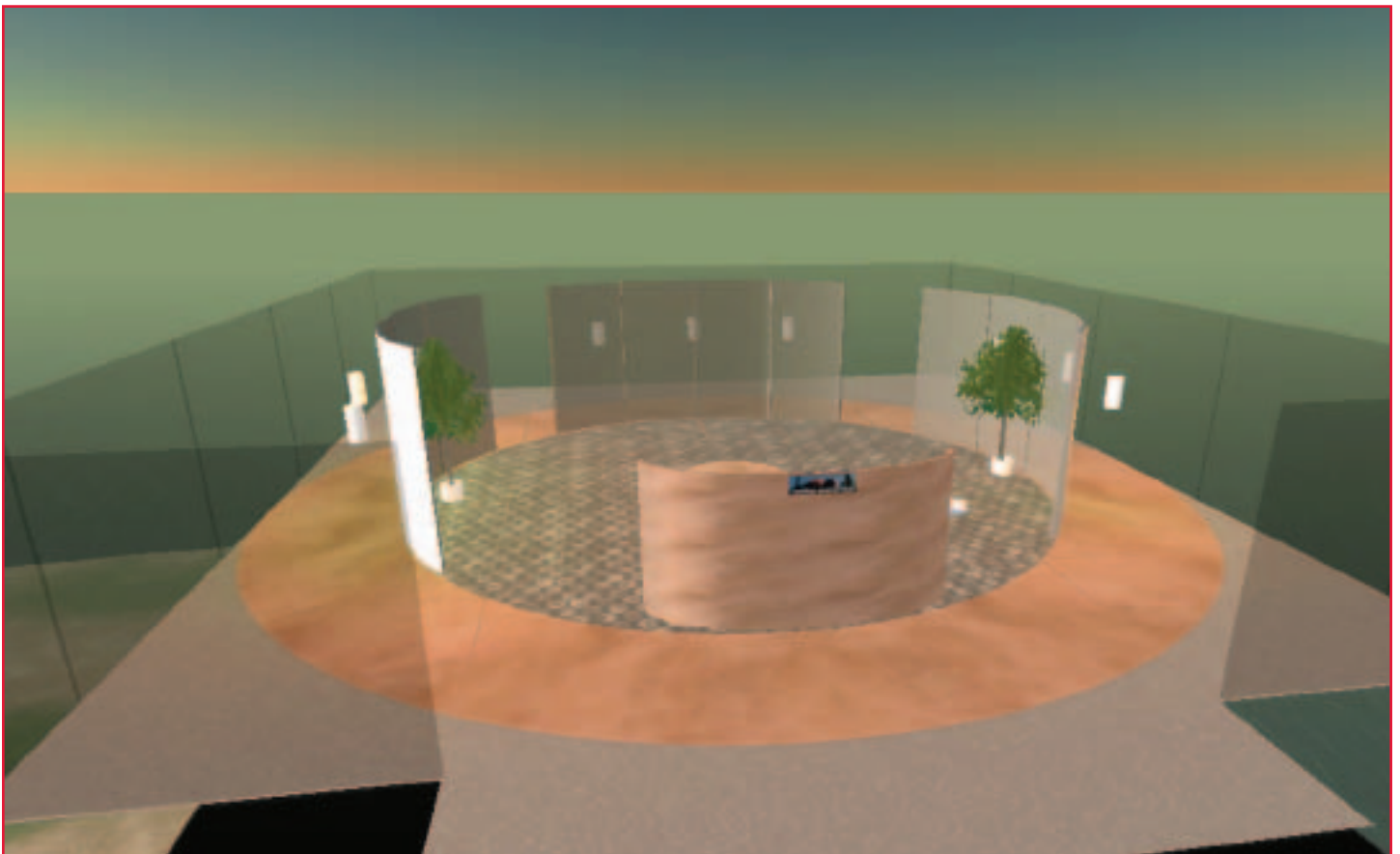

Butler Rooftop Poetry Area

Awards February 2007–March 2007

JANUARY 2007

N. John Popovich

Orleans Niagara BOCES
Orleans-Niagara Career Fairs

\$5,000

Funding for this project will be used to provide a career fair to Orleans-Niagara students.

Kevin Williams

NASA Goddard Space Flight Center
Geomorphic Evolution in Margaritifer Sinus, Mars

\$34,928

The main objective of this research is to detail local geologic and geomorphic relationships in the mapping area to further evaluate hypotheses on the origins of valley networks. In generating detailed geologic maps using existing data from the Viking Orbiter, Mars Global Surveyor, and Mars Odyssey missions, this project will constrain the timing of erosional, depositional, tectonic, volcanic, and impact events that took place in the Himera-Samara Valles and Parana-Loire Valles to understand the geologic history of those regions. *NOTE: This award was made to Dr. Williams while employed at the Smithsonian Institution and was transferred to Buffalo State when Dr. Williams accepted employment here.*

FEBRUARY 2007

Chris Pennuto

New York Sea Grant Institute
Assessing Barriers to Round Goby Invasion of Great Lakes Tributary Streams

\$43,584 (year 1 of 2)

Funding has been received to support research which will document the physical limits and necessary substrate and flow conditions allowing round gobies to pass existing structures in Great Lakes tributary streams.

The round goby has had a significant impact in the Great Lakes since its invasion less than 15 years ago and it is now migrating into tributary streams. The likely impacts to stream communities and ecosystem functions are even greater than those documented within the Lakes. We know little about the ability of this fish to by-pass barriers (e.g., waterfalls, fish ladders, lowhead dams), preventing accurate assessment of streams at risk to invasion or whether proposed fish by-pass structures might facilitate its upstream invasion.

Betty Cappella

NYS Office of Children & Family Services
AmeriCorps State Sub-Award Planning Grant for Family Literacy*

\$48,699

This planning grant project is to ensure that at-risk children in urban and rural areas of Western and Central New York succeed in public school and at home through family literacy programs. The planning grant will develop a strategic plan to work with school districts to: increase social development and student reading performance, educate parents as partners in their child's education, train teachers in scientifically based curriculum and to provide trained tutor-mentors who will help at-risk children become partners in their own education in literacy and in other academic areas.

William F. Wieczorek

Western New York Council on Occupational Safety and Health
Evaluation of the Safe Patient Handling and Movement Project

\$15,990

The Center for Health and Social Research will work directly with the administration and staff of the Western New York Council on Occupational Safety and Health, participating health care facilities, and

staff affiliated with the Safe Patient Handling and Movement Project to conduct the first year of evaluation of this initiative. The project is designed to utilize a best practices model for improving the safety of health care workers and patients by reducing injuries and other problems associated with the handling and movement of patients. The expectation is that this project will receive multiple years of funding to allow for the collection of adequate follow-up data to assess the longer-term impact of the initiative.

Jill Singer

Principal Investigator
Co-PI's: Valentin Brimkov, David Kukulka and Daniel Maclsaac
National Science Foundation
S-STEM Program

Connect With "Science": Opportunities in Science, Technology, Engineering and Mathematics

\$500,000

The S-STEM program at Buffalo State College will provide a minimum of twenty-eight scholarships to science, technology or mathematics undergraduate majors during each year of this program. Selected students will be eligible for up to eight semesters of scholarship support. If some students become ineligible, or encounter other difficulties that make them no longer qualified for scholarship support, other students will be recruited to replace them to maintain cohort size. Recruitment efforts will be coordinated with the College's Admissions Office and specific activities in the public high schools that emphasize math and science college preparation courses, including schools with significant underrepresented student populations. Once recruited into the program, scholarship recipients will be encouraged to take advantage of student support services designed to increase student success. These

Awards (continued)

activities include initiatives being implemented as part of our five-year NSF-STEP project, and additional activities introduced as part of this proposed effort.

Ronald George

New York State Office of Alcoholism and Substance Abuse Services (OASAS)

Underage Drinking: Not a Minor Problem

\$3,000

This award will be used to disseminate the new OASAS *Underage Drinking: Not a Minor Problem: College Edition* media campaign materials, which will be incorporated into the College's existing prevention plans, targeting both on-and off-campus students.

Ilya Grinberg

National Grid

Request for Lab Equipment Support

\$5,000

Ferguson Electric

\$500

Dr. Grinberg has received a total of \$5,500 from National Grid and Ferguson Electric to purchase power electronics/variable speed drives.

MARCH 2007

Amy McMillan

Environment Canada

Loons Genotyping

\$8,319

For this project, Dr. McMillan will genotype 186 loon samples using microsatellite markers, provide a description of analytical methods and QA/QC protocols, and compare the genotypes of these Canadian loons to existing information for U.S. populations.

CONTINUATIONS

Gordon Fraser

U.S. Army Corps of Engineers

Soil and Water Assessment Tool (SWAT)

Modeling for the Cattaraugus Creek Watershed

\$39,838 (year 2 of 2)

Funding has been received for the second year of this project, the goal of which is to extend the Better Assessment Science Integrating Point and Non-point Sources (BASINS) database and Soil and Water Assessment Tool (SWAT) model, already developed to understand the sediment transport problems experienced by the watershed from the watershed, to include the Cattaraugus Creek watershed. The SWAT model was developed to predict the impact of land management practices on water, sediment and agricultural chemical yields in large complex watersheds with varying soils, land use and management conditions over long periods of time. The BASINS system is particularly useful to local stakeholders and decision-makers such as planning commissions and local governments. By using BASINS as the organizing structure for this study, a system would be developed not only for sediment transport modeling, but also for land use planning. Possible planning applications include: evaluating the impact of major land development projects on peak flow, sedimentation, and water quality, and predicting the effects of gradual conversion of land from undeveloped to highly urban use and the related impacts on the watershed. The system could also evaluate the benefits of alternative management strategies including buffer strips, conservation tillage practices, and other best management practices (BMPs), proposed for the watershed to reduce sources of pollutants and their transport through the stream system into Lake Erie.

Kelly Marczynski

PreventionFocus

PreventionFocus Evaluation

\$25,000

The Center for Health and Social Research (CHSR) will continue to work directly with management and staff to ensure that reliable and valid methods are utilized to obtain information relevant to the implementation, assessment, and evaluation of prevention services provided by Preventionfocus. The purpose of this project is to ensure that Prevention focus is obtaining and analyzing data that are required to document both the provision of services and the impact of those services.

Research and Creativity Council

INCENTIVE FUNDS AWARDS

APPLICANT: Rudolph P. Mattai

TITLE: Developing an International Teacher Education Program: Teacher Preparation, Program Development & Evaluation, and Internationalizing the Curriculum

AMOUNT FUNDED: \$6,000

SUMMARY: This proposal is constructed with a deliberate aim to create an environment within the State University of New York College at Buffalo (SUCB) that will enable the institution to respond to funding opportunities aimed at addressing challenges articulated by the World Bank, UNESCO, and the Inter-American Development Bank, inter alia. The following are the goals and objectives of the proposed project:

- To prepare teachers for engagement in schools in an international arena;
- To provide avenues for SUCB to exploit opportunities to compete for international projects which encompass the capacity of the institution; and
- To provide opportunities for various constituencies within SUCB to develop competencies that address the notion of internationalism



Buffalo State College
1300 Elmwood Avenue
Bishop Hall
Buffalo, NY 14222

THE RESEARCH FOUNDATION
The State University of New York

THE RESEARCH FOUNDATION POST

Terry Arnold Receives National Student Exchange Award



Terry Arnold received an **Outstanding Contribution Award** at the National Student Exchange (NSE), 34th Annual Conference in Boise, Idaho (March 6-10, 2007). Terry Arnold is employed by the Research

Foundation of SUNY College at Buffalo in a grant-supported position with the National Student Exchange Program (NSE) in Fort Wayne, Indiana.

The purpose of NSE is to provide an opportunity for students in higher education to exchange from one university to another within the United States and Canada. NSE operates along the principles of a study abroad program except that exchanges are limited to North America. Since NSE's founding 39 years ago, 85,000 students have had an opportunity to see new places; meet new people; diversify their educational backgrounds; and expand their personal, cultural, and academic horizons.

Terry has worked with the National Student Exchange program since 1987.

She handles with ease the daily challenges of responding to a diverse group of college administrators and their needs at NSE's 190 colleges and universities around the U.S. and Canada. While she is efficient in handling business, she also has established a personal rapport with coordinators. Because of her personal interest in members of the NSE family, she volunteered to coordinate NSE's new encouragement team.

At her recommendation, the NSE Council changed the billing year for student application fees, and she designed the billing process. Each year she has streamlined the laborious and time-consuming task of preparing the *NSE Directory* for final edit and publication. She has improved office and on-site registration processes for the annual conference and has become the interface with the hotel in matters related to participant room reservations. She has listened to coordinator requests for needed conference reports and has worked with Bryant to better respond to those requests. She has suggested and designed ways to improve the process whereby RA applications are handled and recently assumed responsibility for the dissemination and tracking of these applications.

**RESEARCH FOUNDATION,
OFFICE OF SPONSORED PROGRAMS
ADMINISTRATION (Room 17)**

Ph.: 878-6700 Fax: 878-4039
Ted Turkle, Director of Research Admin. & Services
Ext. 211; turkleeh@rf.buffalostate.edu

PRE-AWARD & CONTRACT SERVICES (Room 24)

Ph.: 878-3047 Fax: 878-4039
Carol Darstein, Pre-Award & Contract Services Coord.
Ext. 215; darsteca@rf.buffalostate.edu

GRANTS MANAGEMENT SERVICES (Room 17)

Ph.: 878-5724 Fax: 878-4039
Linda Dubrawsky, Associate Director of
Finance & Grants Management
Ext. 210; dubrawla@rf.buffalostate.edu

HUMAN RESOURCES (Room 14)

Ph.: 878-4046 Fax: 878-3046
Sandra Cochran, Human Resources Coordinator
Ext. 204; cochrasa@rf.buffalostate.edu

PURCHASING SERVICES (Room 28)

Ph.: 878-4144 Fax: 878-4039
Carol Julian, Purchasing Coordinator
Ext. 206; julianca@rf.buffalostate.edu

Ellen Errigo, RFP Editor, 885-4309
errigoer@rf.buffalostate.edu

**The Research Foundation
The State University of New York**

Buffalo State College
1300 Elmwood Avenue
Bishop Hall
Buffalo, NY 14222

716-878-6700 PH
716-878-4039 FAX
www.rf.buffalostate.edu



THE RESEARCH FOUNDATION
The State University of New York